

Technical Specifications

Power supply	CR2032 battery
Interfaces	Loxone Air: 868MHz (SRD Band Europe), 4 channels available 915MHz (ISM Band Region 2), 10 channels available max. Power 3.16mW
Sensor	Reed contact
Ambient temperature	0 ... 55°C / 32 ... 131°F
Battery lifetime	up to 2 years
Humidity	max. 95% r.H. (non condensing)
Learn button	can also be used as a push button
Safety rating	IP20
Maintenance & Cleaning	This device is free of maintenance and may only be cleaned with a dry cloth.

LOXONE

Need Help?

loxone.com/support

Loxone Electronics GmbH
Smart Home 1
4154 Kollerschlag
Austria

loxone.com

V060420



LOXONE



Door & Window Contact Air

Part No: 100210 (white)

Part No: 100213 (anthracite)

About the product

The Loxone Window & Door Contact will quickly detect any open windows or doors in your smart home and similar non safety critical applications.

Features

- 1 reed contact
- 1 push button

Installation & electrical connection

If the device is not installed according to manufacturers guidelines the protection of the device may be affected.

Information

Contains FCC ID: COR-ZWIR4512AC1

This device complies with part 15 of the FCC Rules.

Operation is subject to the following two conditions:

1. This device may not cause harmful interference
2. This device must accept any interference received, including interference that may cause undesired operation

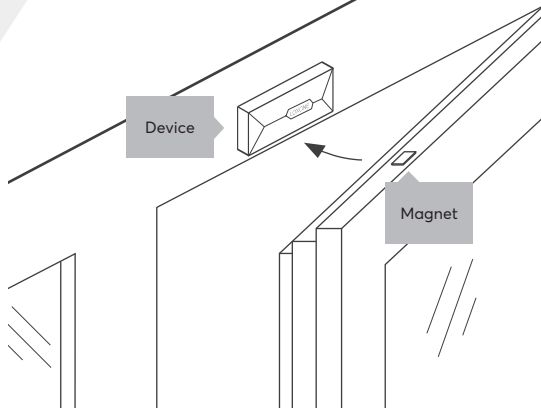
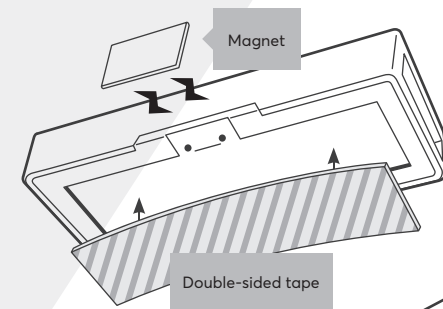
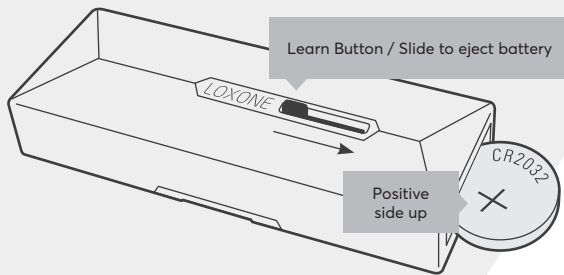

For additional information, declaration of conformity, visit www.loxone.com/help/air